

C2533 203 COLONIAL CABINET PULL HANDLE

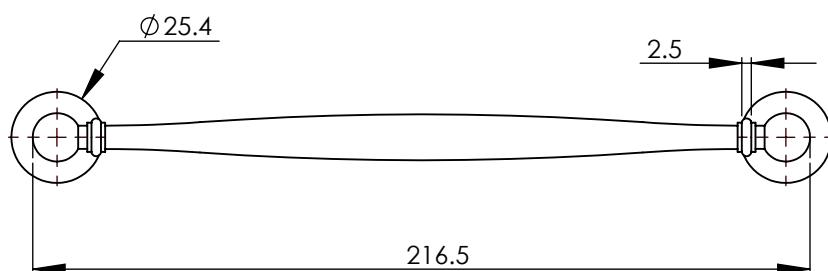

2



1

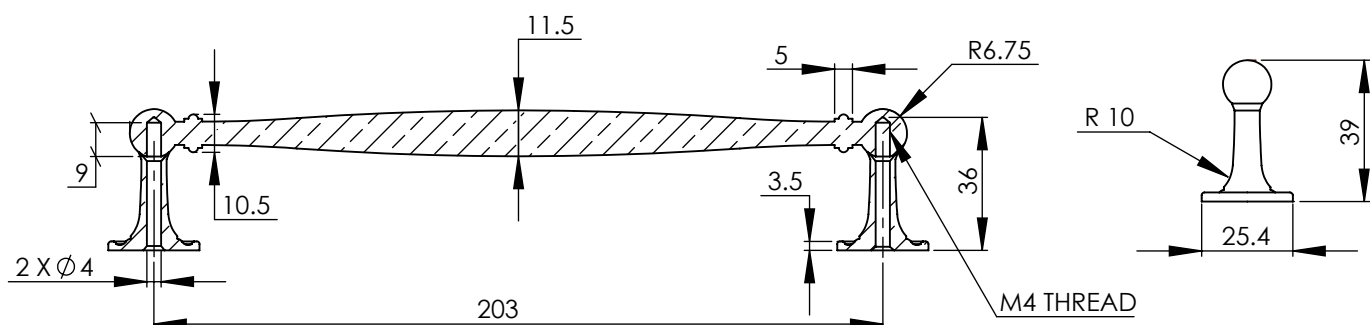

2

Dimensions:
see the outlines given above

3

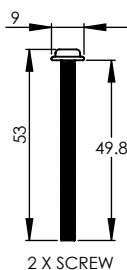

FINISHES

- ME Matt Bronze finish
- SE Satin Brass finish
- PN Polished Nickel finish
- SN Satin Nickel finish
- AT Antique Brass finish
- SR Satin Rose Gold finish
- SC Satin Chrome finish
- PE Polished Brass finish
- PC Polished Chrome finish

Overview

1

Cabinet Pull
illustrated

2

General Dimension
of Cabinet Pull

3

Supplied with:
2x 50mm machine screw

M Marcus Ltd., Dudley

Product Code

C2533 203

Material

Solid Brass

Sizes shown are in mm and approximate.
We reserve the right to amend where
necessary and without any prior notice.